

# AC118S

## 18" High Power Subwoofer System

### Key Features:

- ▶ High power and long excursion driver for lower frequency reproduction.
- ▶ High sensitivity with lower power compression
- ▶ Large port for high output and low-frequency reinforcement
- ▶ Multiple Attachment Points for Ultimate Flexibility
- ▶ Robust 18 mm multiply hardwood with textured black finish

### Applications:

- ▶ Performing Spaces
- ▶ Clubs & Bars
- ▶ Houses of Worship
- ▶ Multi Media Spaces
- ▶ Retail & Hospitality Spaces
- ▶ Presentation Suites
- ▶ Educational Facilities

AC118S is a high power subwoofer system comprised of one 459 mm (18 in) low frequency driver in a vented, front-loaded configuration for extended bandwidth. The rectangular cabinet is fitted with M10 threaded suspension points for ultimate flexibility.

As a part of JBL's AE Application Engineered Series, a versatile family of loudspeakers for a wide variety of fixed installation applications, AC118S provides a natural low-frequency sound quality.



### Specifications:

<b>System:</b>	
Frequency Range (-10 dB) <sup>1</sup> :	32 Hz - 250 Hz
Frequency Response (±3 dB) <sup>1</sup> :	40 Hz - 250 Hz
System Sensitivity (1w @ 1m) <sup>1</sup> :	95 dB
Nominal Impedance:	8 ohms
Maximum SPL(1m) <sup>2</sup> :	122 dB (128 dB peak)
Power Rating <sup>3</sup> :	450 W/900 W/1800 W (Continuous/Program/Peak)
2 hr Power Rating <sup>4</sup> :	600W (2400W peak), 2 hrs
System Power Rating (AES):	
<b>Transducers:</b>	
Low frequency driver:	1 x 18" woofer (P/N: 5021800), 459 mm (18 in) driver with 75 mm (3 in) voice-coil
<b>Physical:</b>	
Input Connector:	Dual Neutrik NL4MP connectors plus covered barrier trip terminals
Enclosure:	18 mm multi-ply hardwood plywood
Grille:	Powder coated, 1.5mm perforated steel, with acoustically transparent black foam backing
Finish:	Textured black paint finish. White (-WH) available upon request. Not available with WRC & WRX finish.
Suspension / Mounting:	12 x M10 threaded suspension points
Dimensions (H x W x D):	548 mm x 561 mm x 720 mm 21.5 in x 22.0 in x 28.3 in
Net Weight:	32.3 kg (71.2 lbs)

<sup>1</sup> Full space (4π) conditions

<sup>2</sup> Calculated maximum SPL based on rated power handling

<sup>3</sup> IEC shaped pink noise with 6dB CF for 100hrs

<sup>4</sup> AES standard, one decade pink noise with 6 dB crest factor within device's operational band, free air. Standard AES 2 hr rating plus long-term 100 hr rating are specified for low-frequency transducers.

JBL continually engages in research related to product improvement. Some materials, production methods and design refinements are introduced into existing products without notice as a routine expression of that philosophy. For this reason, any current JBL product may differ in some respect from its published description, but will always equal or exceed the original design specifications unless otherwise stated.

# ▶ AC118S 18" High Power Subwoofer System

## Frequency Response, 1W/1m:

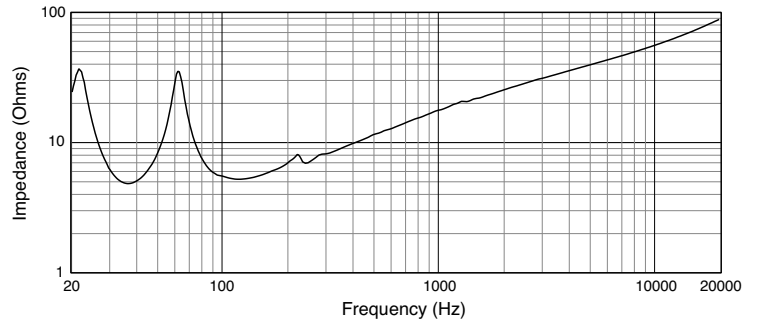
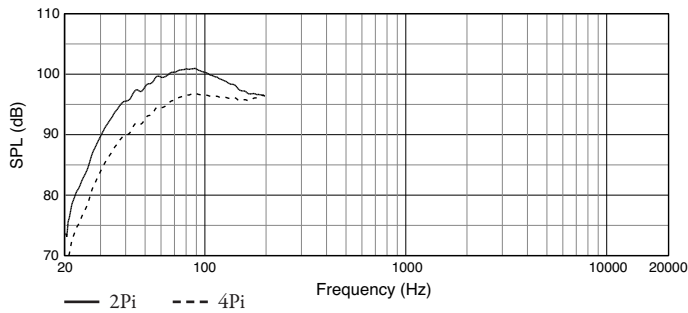

## Dimensions:

Dimensions in mm (inch)

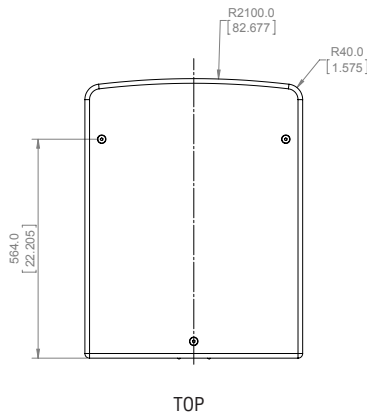
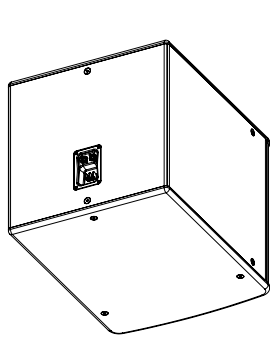
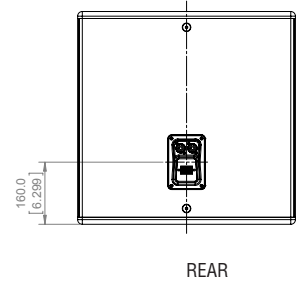
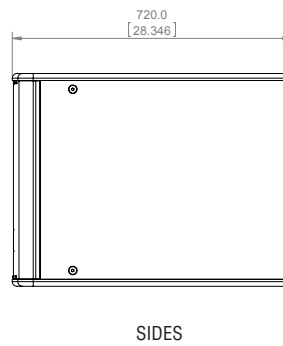
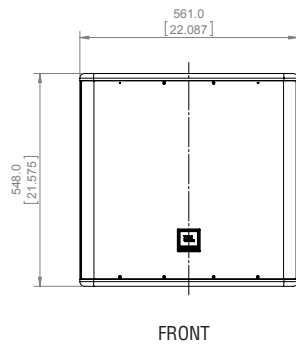
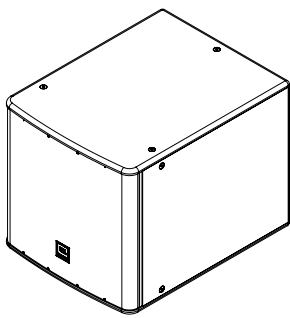

JBL Professional  
 8500 Balboa Boulevard, P.O. Box 2200  
 Northridge, California 91329 U.S.A.  
 © Copyright 2015 JBL Professional  
 www.jblpro.com

AC118S  
 SZ  
 07/15